

Time	
8:45 - 8:50	Year 7s go to ' <i>Home Rooms</i> ' *
8:50 - 9:00	Tutor time
9:05 - 10:20	Lesson 1
10:25 - 11:40	Lesson 2
11:40 - 12:10	Break 1 / Early Lunch
	5 minutes movement time
12:15 - 13:30	Period 3
13:30 - 14:00	BREAK 2 / Late Lunch
	5 minutes movement time
14:05 - 15:20	Period 4



**Bramcote College**  
A member of The White Hills Park Trust

**\*Year 7 timings are 5 minutes earlier to the start of all lessons and 10 minutes early for Late Lunch**

## ***Year 7***

- ✓ Year 7s will enter site via main gates and will be first into the building, starting tutor time at 8:45am
- ✓ Year 7s will be based in English rooms (second floor)
- ✓ Year 7s will use the main staircase (previously the 'down' stairs) which is accessible from the playground
- ✓ **The Year 7s timetable is off-set by 5minutes at the start and end of each lesson, plus an early late (second) lunch (10mins)**
- ✓ **Year7s school day will end at 3:15pm (Ten Minute Corrections until 3:25pm)**
- ✓ **Exclusive use of English floor toilets**

## ***Year 8***

- ✓ Year 8s Enter the school site via main gates
- ✓ Year 8s are based in Maths rooms (Third floor)
- ✓ Year 8s will go up and down the Foyer stairs (previously the up stairs)
- ✓ Year 8s can enter the building via the library double glass doors and then cross the foyer
- ✓ To leave the building Year 8s will come down the foyer stairs and go along the long corridor to student support and leave through the double doors by Mrs Gale's office
- ✓ Exclusive use of maths floor toilets



## **Year 9**

- ✓ Year 9s will enter site via main gates
- ✓ Year 9's are based in the Languages / Social Sciences classrooms above Student Support
- ✓ Year 9s can access their home rooms using the Student Support double doors (right hand side on entry/ left hand side on exit)
- ✓ Year 9s can use the Tech toilets\* using the one-way system (marked out on the floor with arrows) to and from the toilets.

\* As most year groups (7, 8, 9 & 11) have access to these toilets using the one-way system at early lunch and late lunch (break & lunch) there will be increased cleaning in addition to the enhanced cleaning rotas which we have in place.

**Students will have most of their lessons in their home rooms (form rooms) e.g. Maths, English, Spanish, Geography, History, RE/Citizenship. Subjects needing specialist equipment e.g. Science, Tech, Art, Computing Music, will be in subject specialist rooms.**



**Bramcote College**  
A member of The White Hills Park Trust

## **Year 10**

- ✓ Enter site via the bottom gates and use back road to science for tutor time
- ✓ Year 10 will have most lessons (which do not need specialist rooms) on the Humanities floor via the main staircase accessed via the playground
- ✓ Year 10 share these stairs with year 7 who will be moving 5 minutes before Year 10 with supervised departure to ensure year 7s to fully exit the tower before dismissing Year 10
- ✓ Use of science toilets and HU floor toilets

## **Year 11**

- ✓ Enter site via the bottom gates and use back road to science and PE for tutor time
- ✓ Year 11 **home rooms** are BU1, SC6 and PE3. When using BU1 & SC6 students will be expected to enter their classrooms ahead of music students
- ✓ Teaching rooms split between home rooms plus the Humanities rooms and PE1 & 2
- ✓ Year 11's will share the foyer stairs with year 8, with supervised/staggered movement
- ✓ Year 11 will follow the one-way system down the stairs, across the foyer and along the long corridor and exit the building via student services
- ✓ Year 11 to wait outside the building and be last in following year 8's up the stairs – duty staff to support
- ✓ Use of PE block toilets (when not in use) and HU toilets (shared with year 10 with additional cleaning rotas in place)

## ***When lessons are NOT in home rooms***

- ✓ **Science** - All year groups will move to science via the top field path and enter the block via the back stairs. Students will be dismissed from the fire exits and move anti-clockwise back to the main building\*
- ✓ **PE** – students will follow the one-way field movement and down the main drive to PE lining up on the car park area \*
- ✓ **Drama** - follow one-way movement across the field and access the classroom via the fire exit doors at the side of the building\*
- ✓ **Music**– follow one-way movement across the field and access the classrooms via the stairs and are expected to line up on the gravel area by the building (year 11's to enter their classrooms before other year groups)\*

\*Students to return to the main building from these subjects across the bottom yard and tennis courts creating an anti-clockwise movement around the yard/ field

- ✓ **Tech/ IT/ Art** - entry via the tech door following the one-way system to the classrooms. Exit area via one-way around to student services and out to the yard



**Bramcote College**  
A member of The White Hills Park Trust

## ***Student Support / Learning Support Groups***

- ✓ Student Support, Forest School and Learning Support are based in the rooms used last year for Learning Support / IMP and RESET.
- ✓ There will be some vertical groups so increased social distancing and protective measures have been put in place
- ✓ IT4 (by Languages) will also be used for some lessons and mentoring sessions
- ✓ Entrance and exit to student support via the one-way double doors by Mrs Gale's office
- ✓ Entrance and exit to Learning Support / Forest School / Reset are also via external fire doors in each room
- ✓ Time slots will be set up for social support for each year group. Students will be told about this personally
- ✓ Students are asked to be conscious of 2m social distancing if they need to come to Student Support to speak to someone through the fire exit.
- ✓ Heads of Year will be relocating to be close to their year group's main teaching rooms / home rooms



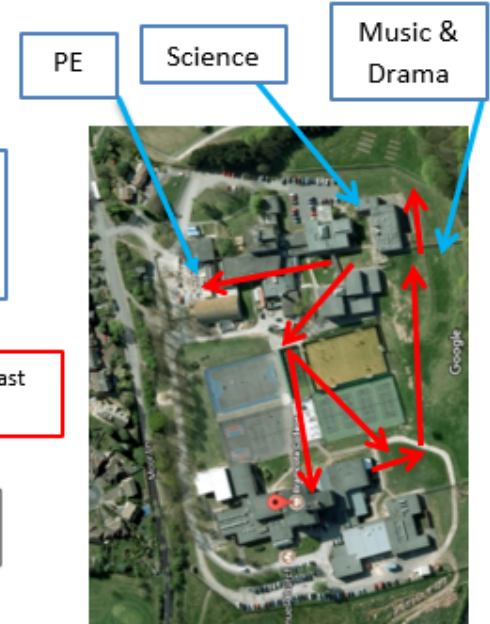
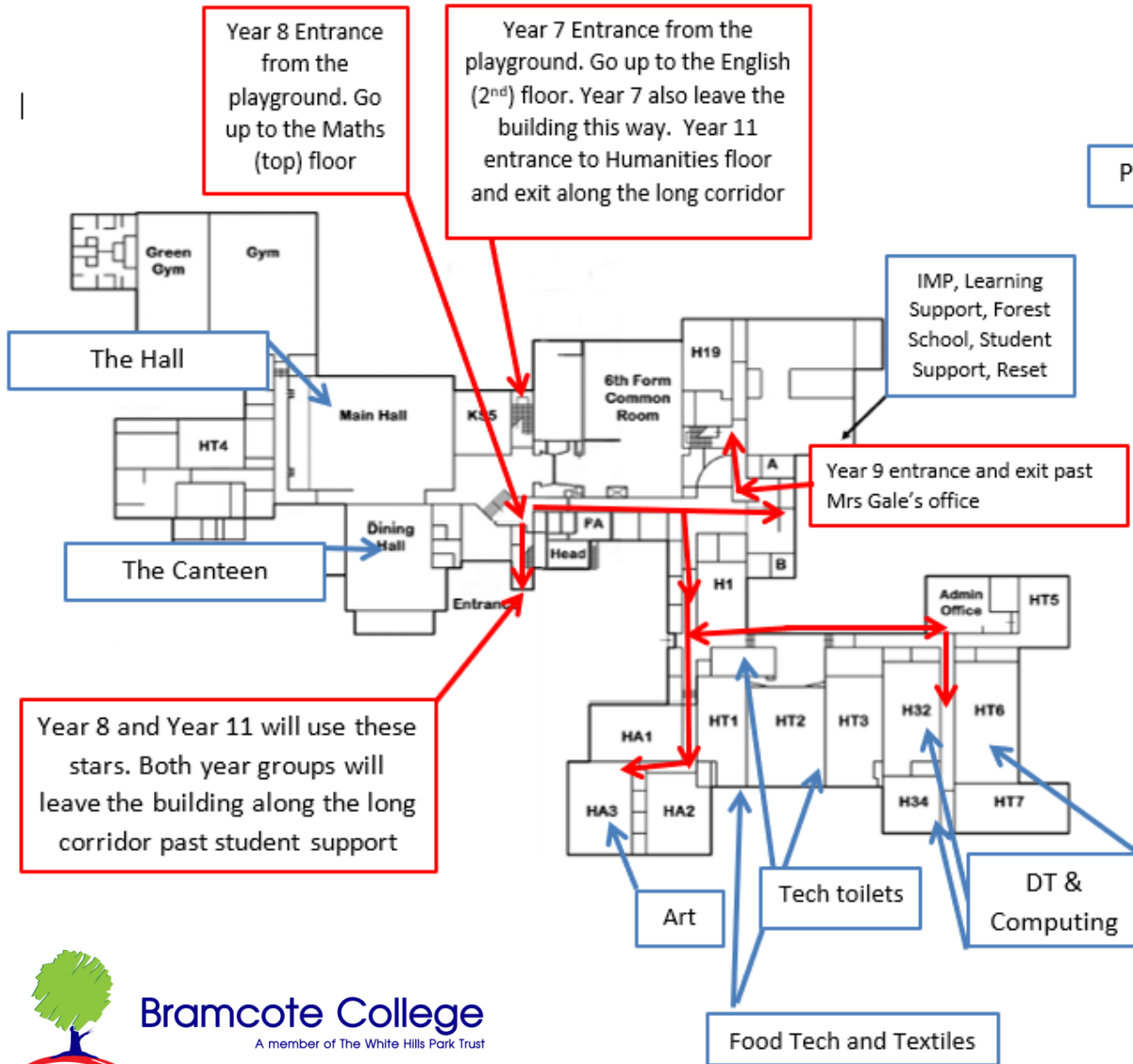

Follow the one-way system – to Science, PE, Music & drama across the field back to the main building year group entrances across the courts



## ***Social Spaces at Break and Lunch time***

- ✓ Top yard (close to the BC6F cabins) - Year 7
- ✓ Tennis Courts – Year 8
- ✓ Bottom Yard - Year 9
- ✓ Field space from Music to the Tree - Year 10
- ✓ Field tree to 6<sup>th</sup> form common room - Year 11
- ✓ MUGA / Astro Turf – Weekly Rotation

During break and lunch time year groups will be able to use their year group staircase to access their designated toilet areas

All year groups can use the one-way system to access the tech toilets (additional cleaning will support this in between social times).



**Bramcote College**

A member of The White Hills Park Trust



## ***Lunch time Rotations***

- ✓ Different year groups will have one designated slot to access the canteen per day; this will be either Early Lunch or Late lunch
- ✓ Students are encouraged to bring a drink and a snack into school\*
- ✓ All students will be offered a breakfast bagel every morning during tutor time, which can be eaten during tutor time, or saved for later.
- ✓ Year 7, 8 & 9 will use the school hall to enter and exit the dining hall and their eating space
- ✓ Students will only have access to the dining hall to purchase food or drinks ONCE daily at either Early Lunch or Later Lunch\*
- ✓ Year 10 & 11 will use the foyer entrance to enter and access the dining hall
- ✓ The indoor spaces are for eating food only, if students are not eating, they will be expected to be outside unless it's raining. There are new benches on site.

**\*As students will only have access to the dining hall to buy food or drinks *ONCE PER DAY* we recommend they bring a snack and a drink from home.**



**Bramcote College**  
A member of The White Hills Park Trust

	School Hall 1 Stage End	School Hall 2 Library End	Dining Hall 1 Window End	Dining Hall 2	
<b>Early Lunch</b> 11:40 – 12:10	Year 9 11:40 – 12:10		Year 10 11:40 – 12:10		
<b>Late Lunch</b> 13:30 – 14:00	Year 8 13:30 – 14:00	Year 7 13:20 – 13:50		Year 11 13:30 – 14:00	
Wet Lunch Times					
<b>Early Lunch</b> 11:40 – 12:10	Year 7 English Home rooms	Year 8 Maths Home rooms	Year 9 School hall	Year 10 Dining Hall	Year 11 Barn
<b>Late Lunch</b> 13:30 – 14:00	Year 7 School Hall 1:20- 1:50 then to Home rooms	Year 8 School Hall	Year 9 Languages floor Home Rooms	Year 10 Top Gym	Year 11 Dining Hall



**Bramcote College**  
A member of The White Hills Park Trust

**As students will only have access to the dining hall to buy food or drinks *ONCE PER DAY* we recommend they bring a snack and a drink from home.**